

NOTE:
PLEASE NOTE THAT ALL ROAD MARKINGS SHOWN ON THIS DRAWING ARE IN ACCORDANCE WITH THE DEPARTMENT OF TRANSPORT "TRAFFIC SIGNS MANUAL" AUGUST 2019.

MALAHIDE ROAD/BACK ROAD UPGRADE PLAN
SCALE 1:200

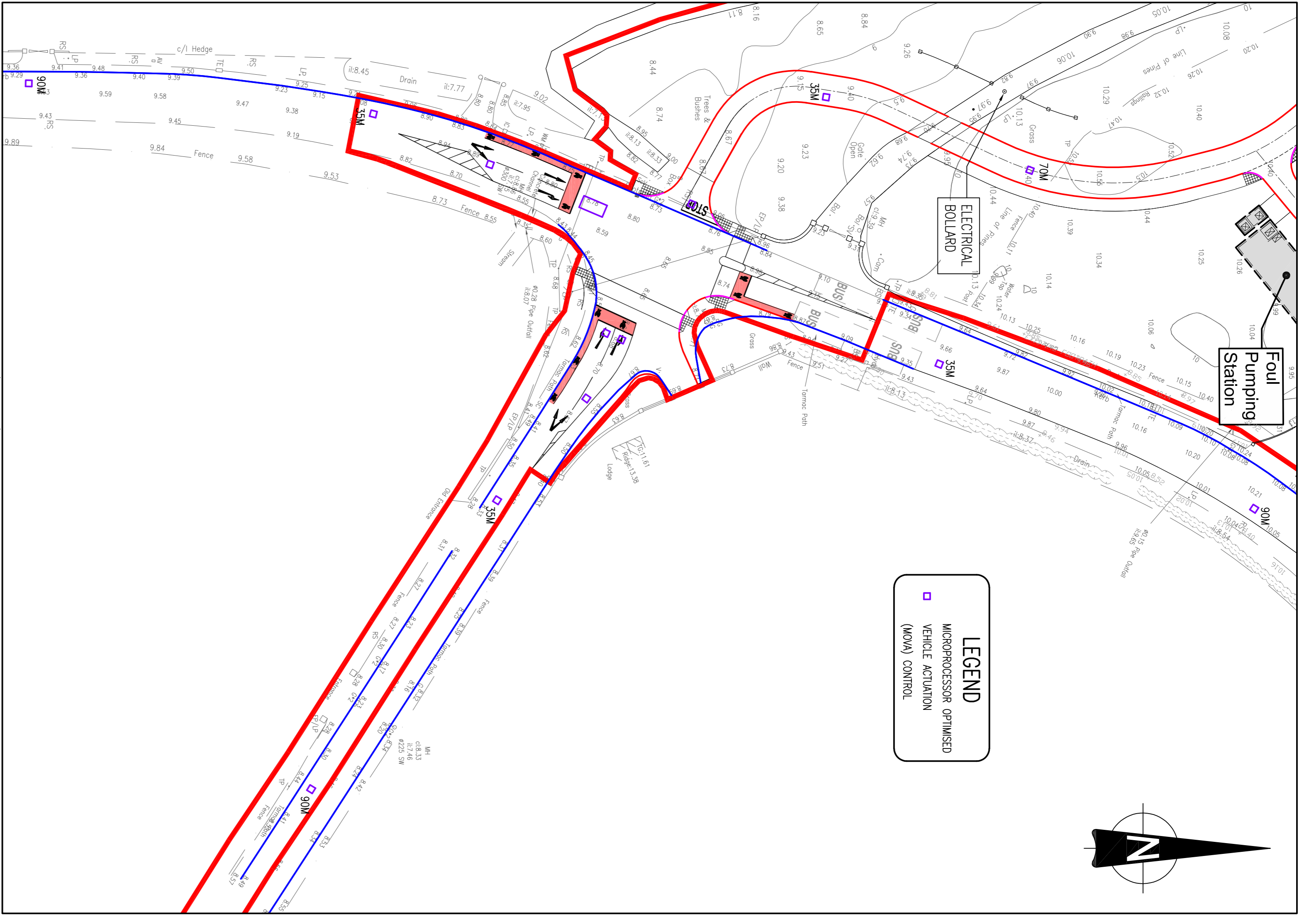

LEGEND
MICROPROCESSOR OPTIMISED VEHICLE ACTUATION (MOVA) CONTROL

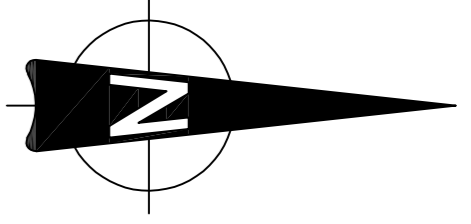

'MOVA' LOCATION PLAN
SCALE 1:300

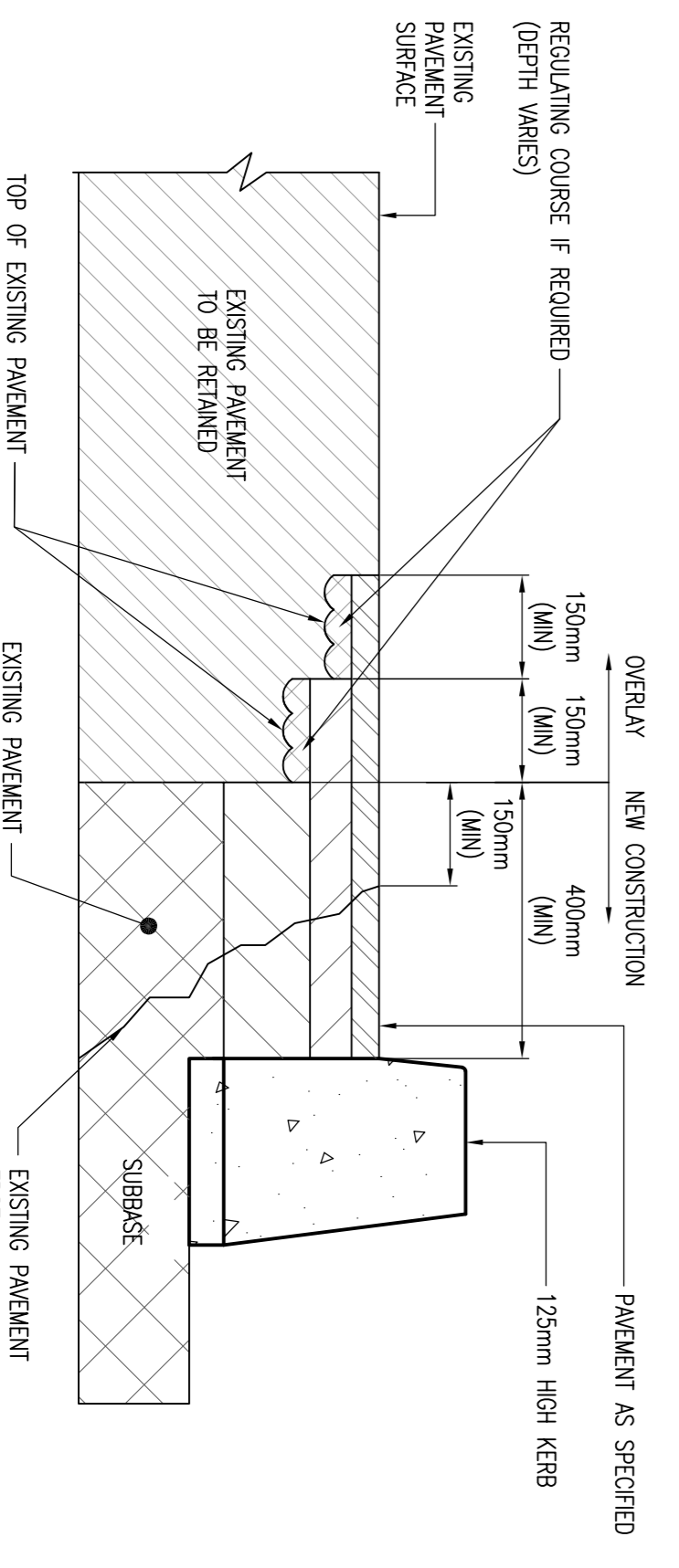

SECTION 1-1
LONGITUDINAL JOINT BETWEEN NEW CONSTRUCTION AND EXISTING ROAD
SCALE 1:10 @ A1

LEGEND:
NEW FOOTPATH CONSTRUCTION
NEW DROP KERB
NEW VERGE
NEW CYCLETRACK
NEW 125mm HIGH KERB
PROPOSED FLUSH KERB
EXISTING KERB LINE

- NOTES:
1. DO NOT SCALE. USE FIGURED DIMENSIONS ONLY.
 2. THIS DRAWING IS TO BE READ IN CONJUNCTION WITH ALL OTHER RELEVANT ARCHITECTURAL AND ENGINEERING DRAWINGS.

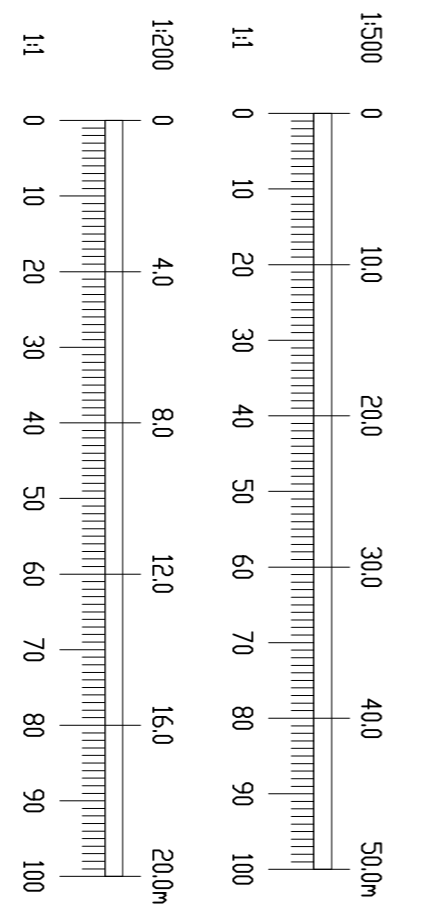

Ordnance Survey Ireland Licence No. EN 0006021
© Ordnance Survey Ireland/Government of Ireland.

REV.	DATE	AMENDMENT	DRN	APPD
A	07/07	REVISED FOR FINAL SUBMISSION		MD

STATUS
PLANNING

Waterman Moylan
Engineering Consultants
BLOCK 5, EASTPOINT BUSINESS PARK, ALFIE BRYNE ROAD,
DUBLIN D03 K7W7 IRELAND.
Tel: (01) 664 8900 Fax: (01) 661 3818
Email: info@watermanmoylan.ie www.watermanmoylan.ie

CLIENT KINWEST LTD
ARCHITECT CONROY CROWE KELLY ARCHITECTS
PROJECT ALBURN, MALAHIDE, CO. DUBLIN

TITLE
PROPOSED MALAHIDE ROAD JUNCTION UPGRADE LAYOUT

DESIGNED	APPROVED	DATE
MD	MD	APR '20

JOB NO.	DRG. NO.	REVISION
19-020	P110	A

SCALE 1:200 @ A1